

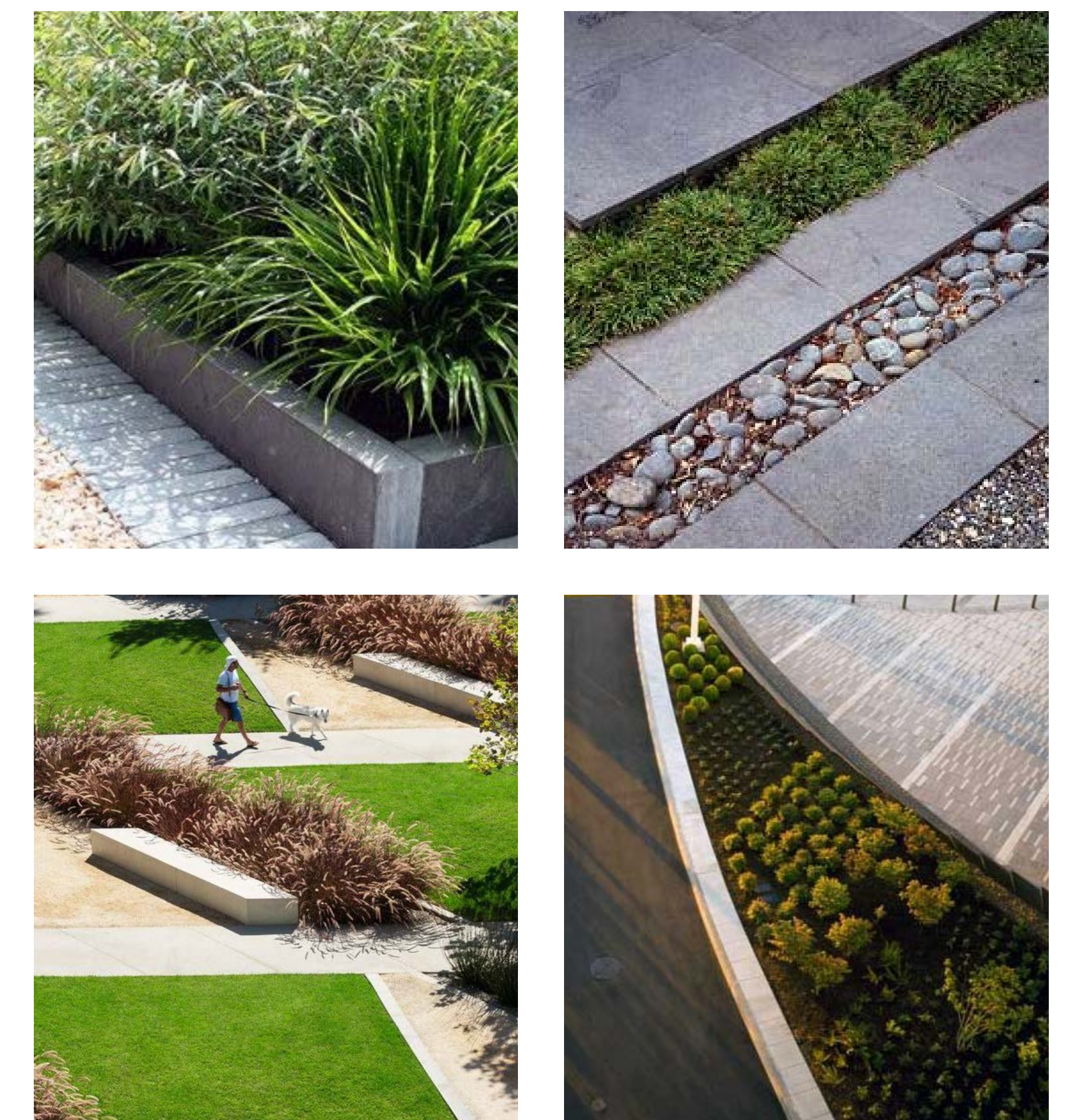

Landscape Masterplan

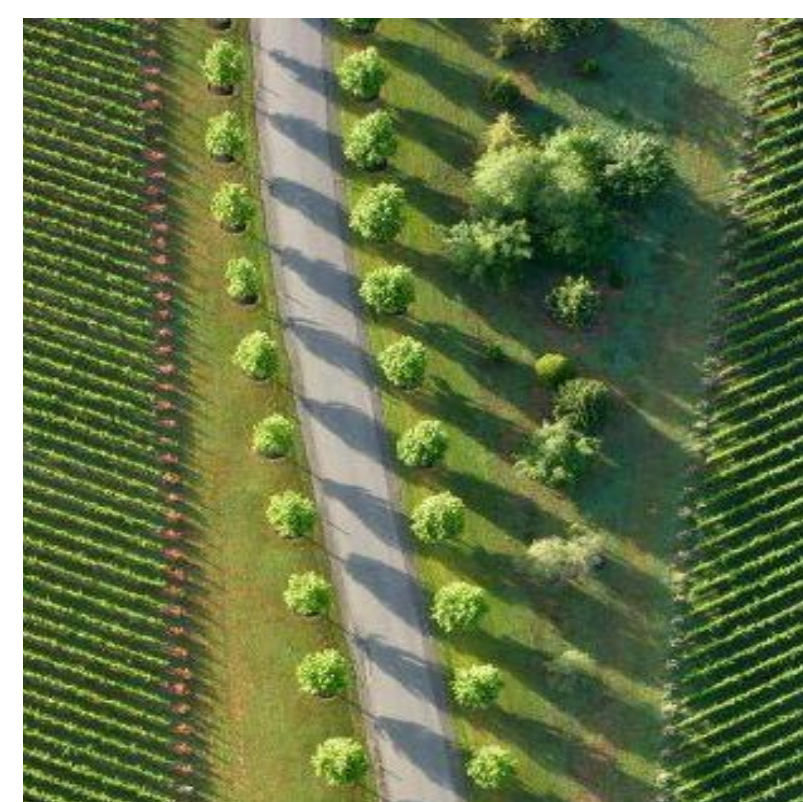

Material selections



Landscape pattern making



Feature deciduous tree



Landscape texture through planting



Medium scale tree planting



Seasonal native planting







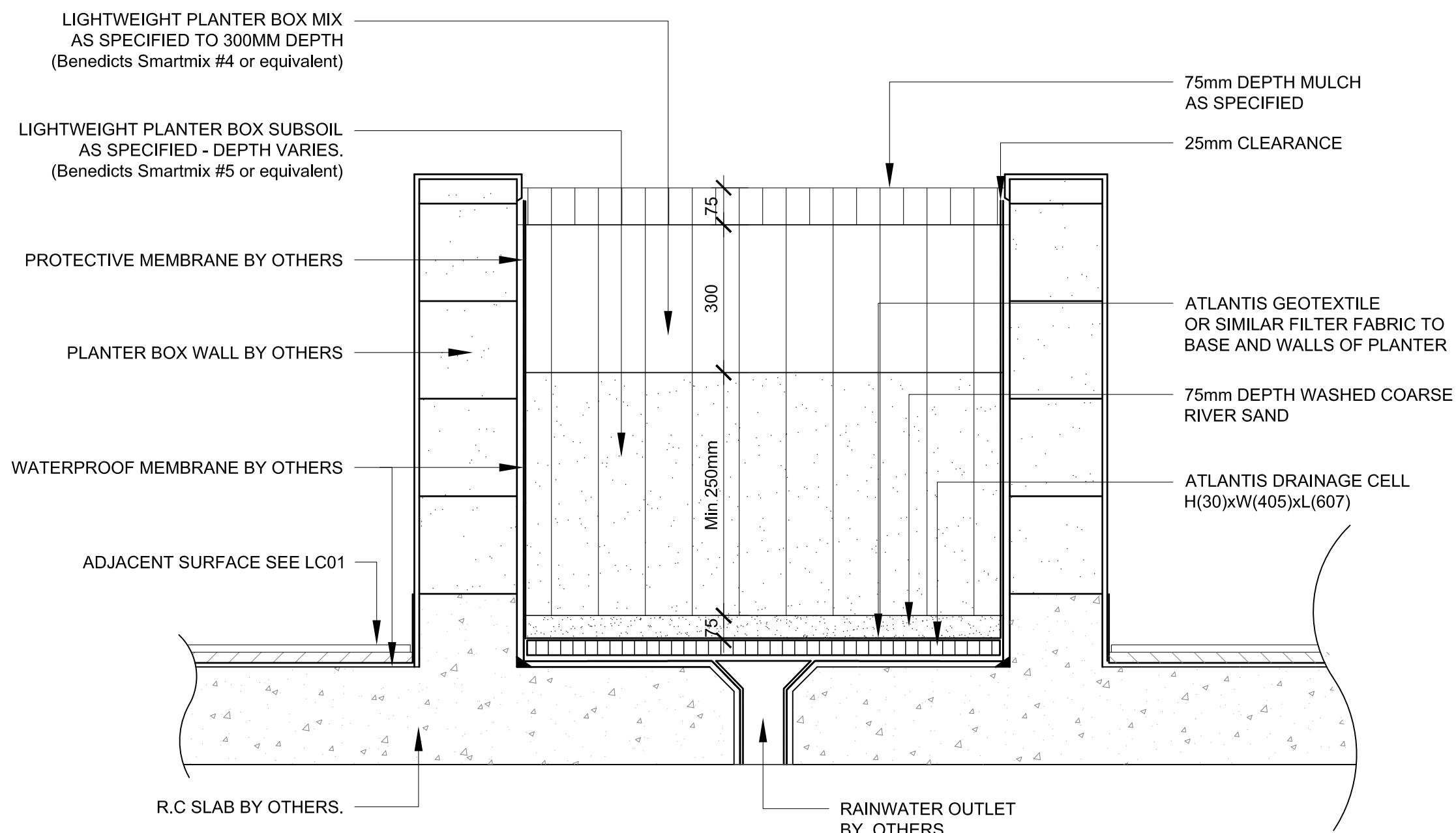

1 RAISED PLANTER BOX  
TYPICAL SECTION 1:10

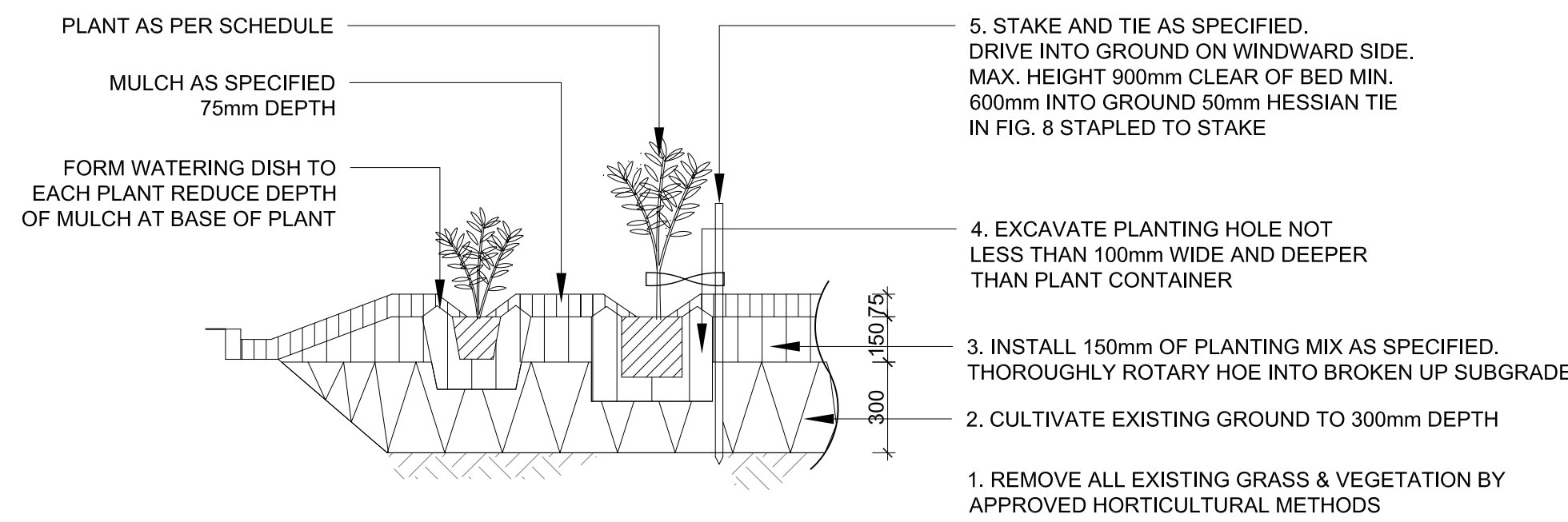

3 MASS PLANTING BED-NATURAL GROUND  
TYPICAL SECTION 1:20

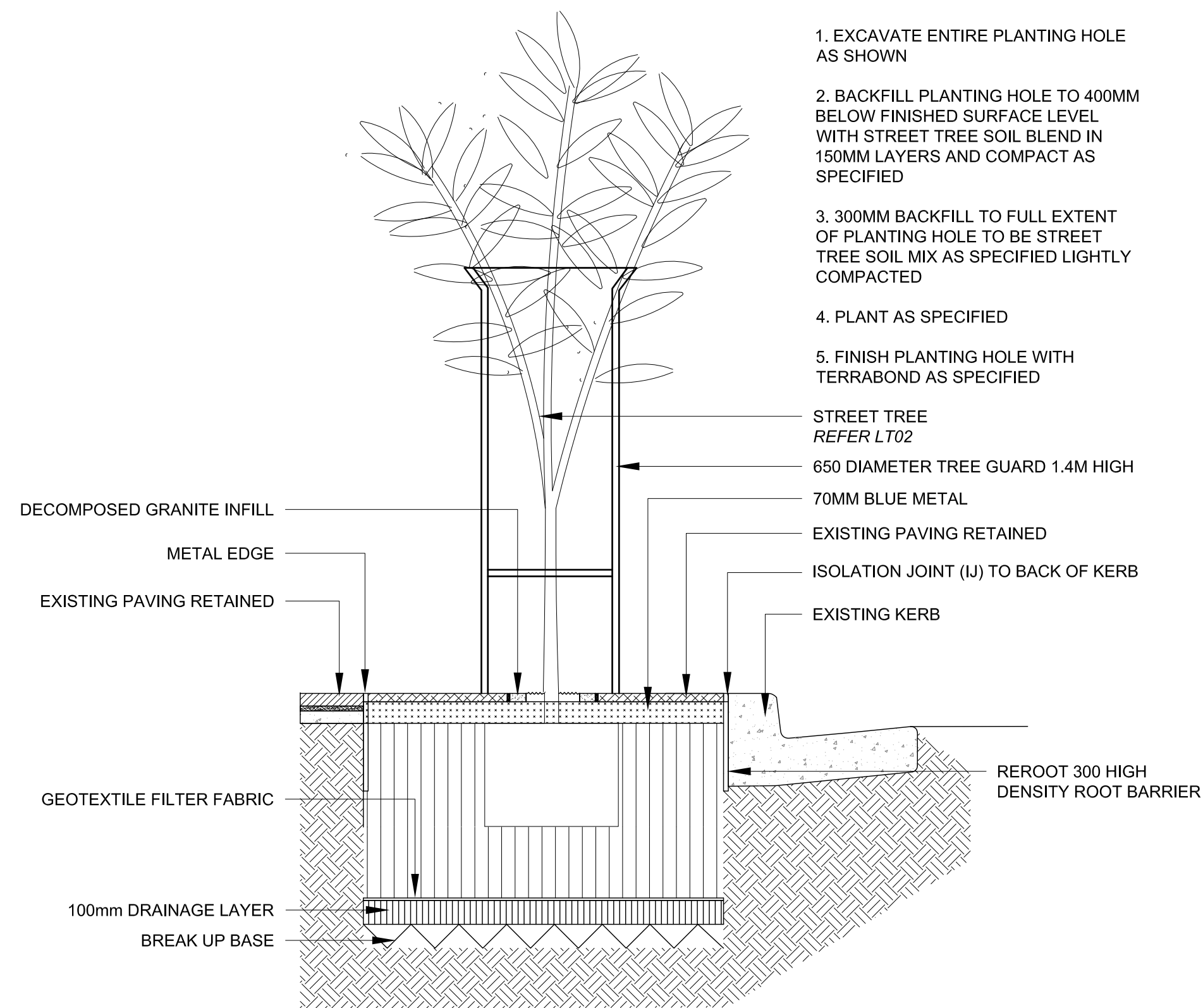

SECTION A - A

2 TYPICAL NEW STREET TREE DETAIL  
SCALE 1:20

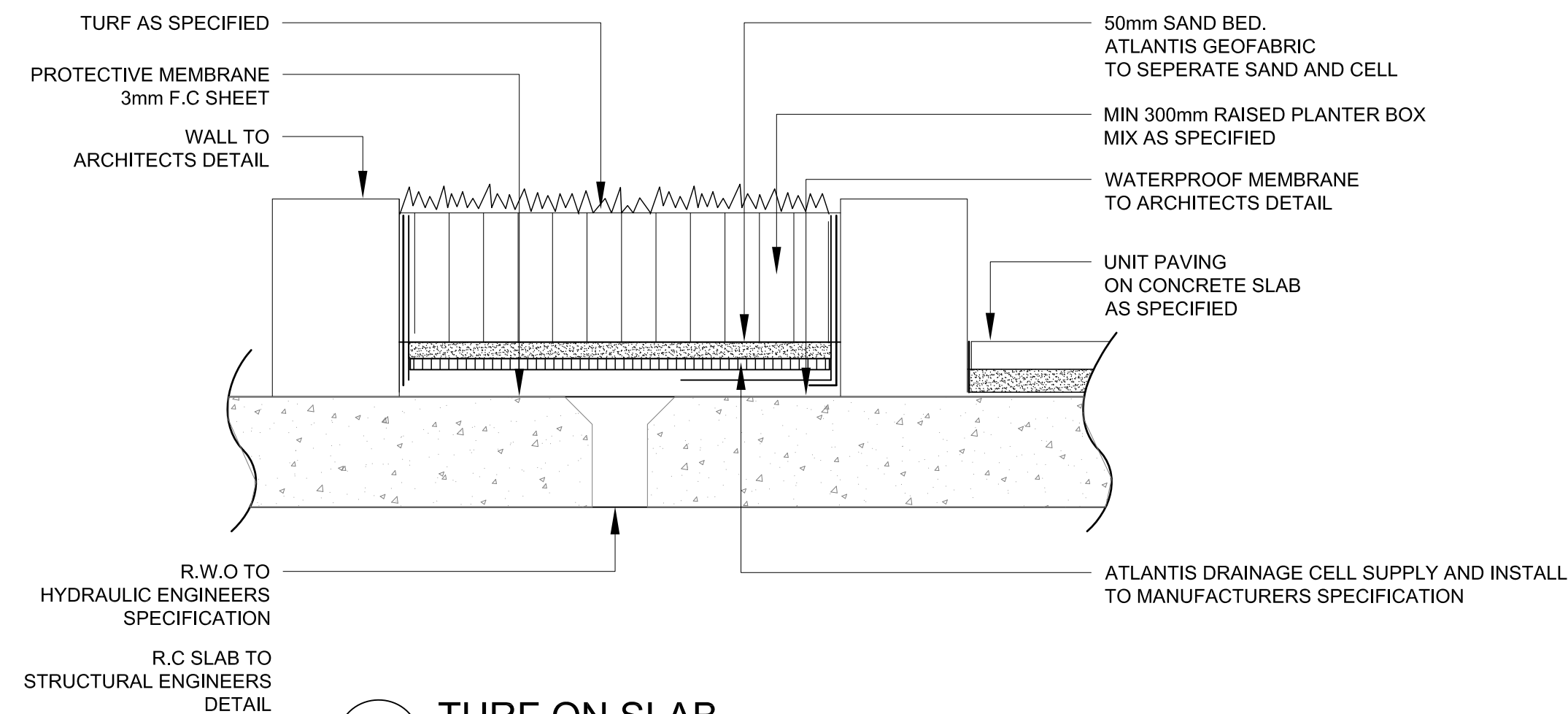

4 TURF ON SLAB  
TYPICAL SECTION 1:10

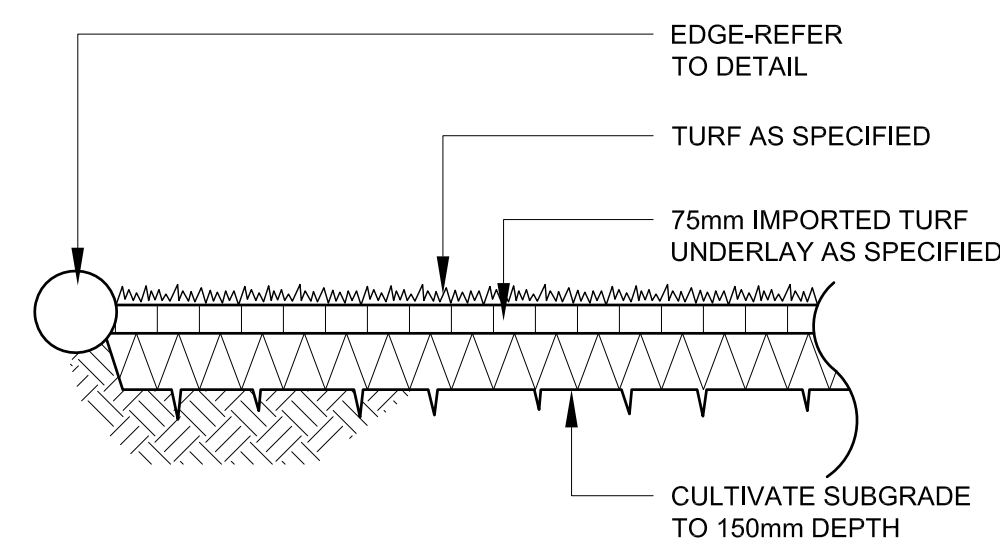

5 TURF ON GRADE  
SECTION 1:20

A For JRPD 04.11.2015  
ISSUE DESCRIPTION DATE

TaylorBrammer

TAYLOR BRAMMER LANDSCAPE ARCHITECTS PTY LTD  
SYDNEY STUDIO  
218 Oxford Street  
Sydney, NSW, 2005  
T 61 2 9387 8855  
F 61 2 9387 8150  
E sydney@taylorbrammer.com.au

PROJECT:  
PROPOSED RESIDENTIAL DEVELOPMENT  
184-182 RESTWELL ROAD, FRANKSWOOD

DRAWING TITLE:  
DETAILS

CLIENT:  
GJW Consultancy

SCALE: 1:100 (B1) CHECKED: JH DRAWING NO: 154465 REVISION:  
DATE: 30.10.2015 JOB NO: 154465  
DRAWN: EJ DESIGNED: JH LA03 A

Copyright of Taylor Brammer Landscape Architects Pty Ltd.  
ABN 61 088 724 988